

Norfolk Vanguard Offshore Wind Farm

Outline Traffic

Management Plan

Figure 10
Deadline 8

Applicant: Norfolk Vanguard Limited
Document Reference: 8.8
Pursuant to: APFP Regulation: 5(2)(q)

Date: 30 May 2019
Revision: Version 3
Author: Royal HaskoningDHV

Photo: Kentish Flats Offshore Wind Farm



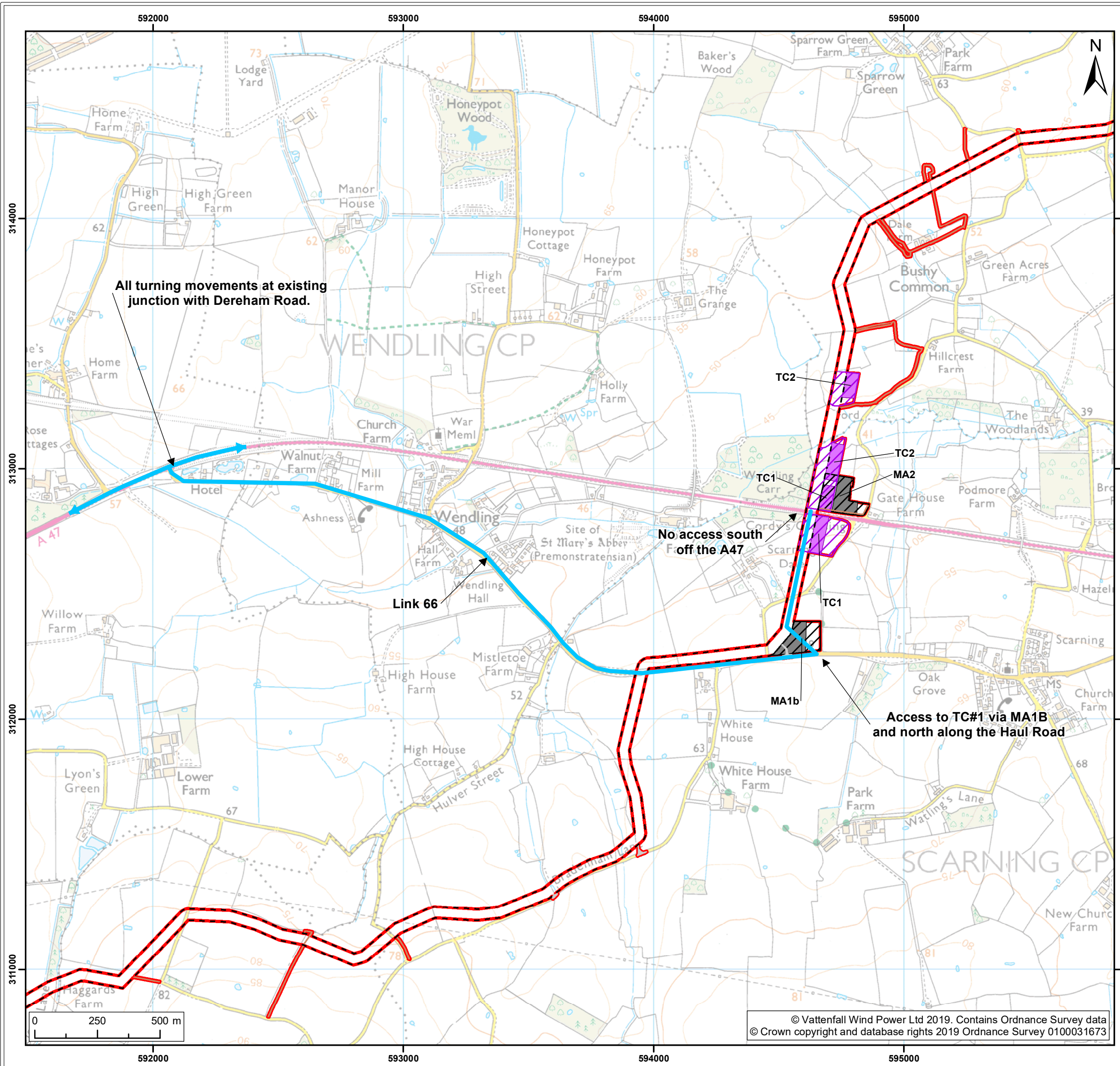

- Legend:
- Norfolk Vanguard onshore red line boundary
 - Onshore cable route
 - Trenchless crossing zone (e.g. HDD)
 - Indicative trenchless crossing compound
 - Mobilisation zone
 - Indicative mobilisation area compound
 - Access
 - Construction access
 - Operation access
 - TC1 south construction vehicle access route

Project:	Report:
Norfolk Vanguard	Outline Traffic Management Plan

Title:

Construction Vehicle Access route to TC1 south (AC163)

Figure: 10		Drawing No: PB4476-008-006-027			
Revision:	Date:	Drawn:	Checked:	Size:	Scale:
02	29/05/2019	LB	CD	A3	1:15,000
01	10/05/2019	JT	CD	A3	1:15,000

Co-ordinate system: British National Grid EPSG: 27700

VATTENFALL



Royal HaskoningDHV
Enhancing Society Together